



## SPANNMITTEL TOOL CLAMPING

Spann- und Vorschubzangen

Collets and Feed Fingers

Führungsbüchsen

Guide Bushes

Spannköpfe

Clamping Heads

Spannhülsen

Bar Feed Collets

<b>WERKSTÜCKSPANNUNG</b>	<b>WORKPIECE CLAMPING</b>		<b>Seite / Page</b>
<b>Spann- und Vorschubzangen</b> für Einspindeldrehautomaten	<b>Collets and Feed Fingers</b> for Single-Spindle-Lathes		1 - 6
<b>Spann- und Vorschubzangen</b> für Mehrspindeldrehautomaten	<b>Collets and Feed Fingers</b> for Multi-SpindleLathes		5 - 8
<b>Abgreifzangen/Synchronspannzangen</b> für Einspindeldrehautomaten	<b>Pick-Up-Collets</b> for Single-Spindle-Lathes		9
<b>Abgreifzangen/Synchronspannzangen</b> für Mehrspindeldrehautomaten	<b>Pick-Up-Collets</b> for Multi-Spindle-Lathes		10
<b>Zugspannzangen</b>	<b>Draw-In Collets</b>		11
<b>Spannköpfe</b>	<b>Clamping Heads</b>		12 - 16
<b>Führungsbüchse</b> mit HM-Einsatz	<b>Guide Bushes</b> with carbide insert		17
<b>Spannhülenlagerungen und Spannhülsen</b> für Lademagazine	<b>Revolving Ends and Bar Feed Collets</b> for Barloaders		18 - 29
<b>WERKZEUGSPANNUNG</b>	<b>TOOL CLAMPING</b>		
<b>ER-Spannzangen</b> Standard, für Gewindebohren o. abgedichtet	<b>ER-Collets</b> standard, for tapping or coolant sealed		30 - 31
<b>OZ-Spannzangen (Reihe 400)</b> einfach und doppelt geschlitzt	<b>OZ-Collets (series 400)</b> single and double slotted		32
<b>ZUBEHÖR</b>	<b>ACCESSORIES</b>		
<b>Spannmuttern und Spannschlüssel</b>	<b>Locknuts and Spanners</b>		33 - 34

## Spann- und Vorschubzangen Collets and Feed Fingers

### Druckspannzangen DIN 6343 (Reihe 100)

Zum Spannen von Werkstücken in Drehmaschinen

### Dead-Length Collets DIN 6343 (series 100)

For clamping of workpieces in automatic-screw-machines

### Rundlaufgenauigkeit nach DIN 6343

Run-out accuracy according to DIN 6343

Ø d mm	l mm	Rundlauf / Run-out mm
1,0 - 1,6	6	0,02
1,6 - 3,0	10	
3,0 - 6,0	16	
6,0 - 10,0	25	
10,0 - 18,0	40	0,03
18,0 - 24,0	50	
24,0 - 30,0	60	
30,0 - 50,0	80	0,04
> 50,0	100	

## Oberflächen der Spannbohrung Surfaces of the Clamping Bore

Glatt



smooth bore

mit Querrillen

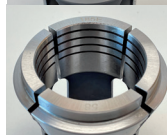

with horizontal grooves

mit Längs- und Querrillen

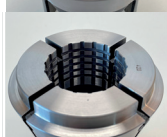

with horizontal and vertical grooves

HM-Bedampft

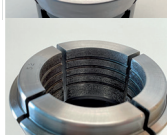

tungsten carbide coated

## Spann- und Vorschubzangen Collets and Feed Fingers

### Druckspannzangen DIN 6343 (Reihe 100)

Zum Spannen von Werkstücken in Drehmaschinen

### Dead-Length Collets DIN 6343 (series 100)

For clamping of workpieces in automatic-screw-machines

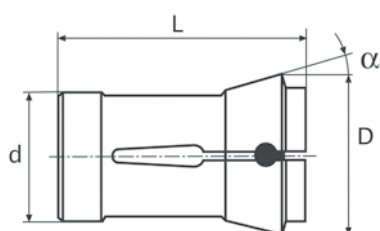

Typ Type	F-Typ F-type	Spannbereich Clamping range	d	D	L	a (alpha)
100E	F6 76-599	1,0 - 4,5	6	10	30	15°
101E	F8 76-577	1,0 - 6,0	8	12	42	16°
109E	F10 76-86	1,0 - 7,0	10	15,5	47,5	20°
110E	F10 76-720	1,0 - 7,0	10	16	43	15°
111E	F10 76-1178	1,0 - 7,0	10	16	46	20°
1155E	F12 76-78	1,0 - 10,0	12	18,1	44,5	15°
116E	F13 76-357	1,0 - 10,0	13	19	63,5	16°
117E	F14 76-98	1,0 - 10,0	14	18	46	13°
120E	F15 76-580	1,0 - 12,0	15	21	64	16°
1212E	EF16-1076	1,0 - 13,0	16	21	64	16°
125E		1,0 - 14,0	17,5	22	51	15°
136E	F20 76-201	1,0 - 16,0	20	26	54	15°
138E	F20 76-87	1,0 - 16,0	20	28	67	16°
140E	F22 76-71	1,0 - 16,0	22	33	55	15°
143E	F25 76-581	1,0 - 20,0	25	31	54	15°
145E	F25 76-64	1,0 - 20,0	25	35	77	16°
147E	F27 76-22	1,0 - 24,0	27	38	72,7	15°
148E	F28 76-93	1,0 - 24,0	28	38	70	15°
1446E	F76-101	1,0 - 26,0	30	38	65	15°
157E	F30 76-63	2,0 - 25,0	30	42	80	16°
161E	F32 76-221	1,0 - 26,0	32	45	75	15°
162E	F35 76-67	2,0 - 25,0	35	43	70	15°
163E	F35 76-94	1,0 - 30,0	35	48	80	15°
1536E	F76-740	1,0 - 32,0	37	47	92	16°
164E	F38 76-72	1,0 - 32,0	38,1	49,2	108	15°
171E	F42 76-99	1,0 - 37,0	42	55	94	15°
173E	F48 76-81	1,0 - 42,0	48	60	94	15°
177E		6,0 - 52,0	58	70	94	15°
185E	F66 76-59	2,0 - 60,0	66	84	110	15°
190E		60,0 - 80,0	88	106	115	15°
193E		20,0 - 80,0	90	107	130	15°

## Vorbau-Spannzangen Extended Nose Collets

**Spannzangen Reihe 100 mit konischem Vorbau**  
zum Einsatz auf der Abgreifspindel

**Collets series 100 with extended nose**  
for pick-up

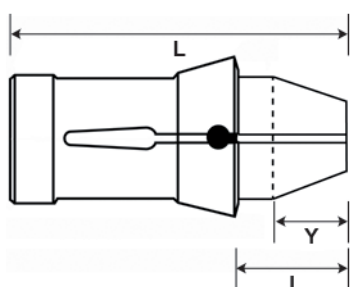

Typ Type	F-Typ F-type	Vorbaulänge Ext. nose length I	Y	L	Spannbereich Clamping range
116E	F13	12	6	70	1,0 - 10,0
120E	F15	15	9	73	1,0 - 12,0
1212E	F16	15	9	73	1,0 - 12,0
136E	F20	15	10	64	1,0 - 16,0
138E	F20 76-2027	20	13	80	1,0 - 16,0
145E	F25	20	10	87	1,0 - 20,0
1446E	F30 76-2019	20	14	79	1,0 - 26,0
1536E	F37 76-2020	25	15	107	1,0 - 32,0
171E	F42	28	19	113	1,0 - 32,0
173E	F48 76-2006	28	19	113	2,0 - 42,0

## Vorschubzangen (Reihe 200)    Feed Fingers (Series 200)

Zum Vorschub des Stangenmaterials in Drehautomaten

For feeding bars in Single-Spindle Automatic Lathes

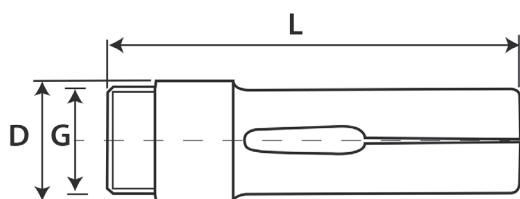

Typ Type	Spannbereich Clamping range	D	L	Gewinde G Thread G
207E	1,0 - 12,0	18	70	M16 x 1 L
217E	3,0 - 16,0	21	70	M20 x 1 L
220E	3,0 - 18,0	24	85	M22 x 1 L
236E	3,0 - 24,0	30	95	M28 x 1 L
237E	3,0 - 25,0	31	90	M29 x 1 L
254E	4,0 - 36,0	42	116	M40 x 1 L
273E	10,0 - 52,0	60	140	M58 x 1 L

## Außenvorschubzangen    External Feed Fingers

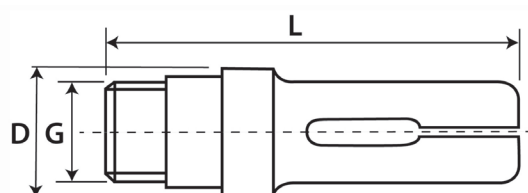

Typ Type	Spannbereich Clamping range	D	L	Gewinde G Thread G
242E	25,0 - 30,0	42	120	M36 x 1,5
259E	37,0 - 42,0	56	138	M50 x 1,5
278E	53,0 - 60,0	75	138	M68 x 1,5

## Mehrspindel-Spannzangen (Serie 9000)    Multi-Spindle Collets (Series 9000)

Zum Spannen von Werkstücken in Mehrspindel-Stangenautomaten

For clamping of workpieces in multi-spindle automatic lathes

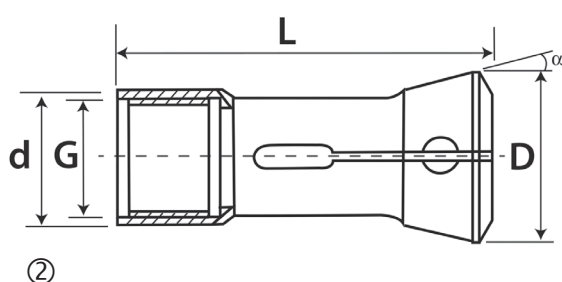
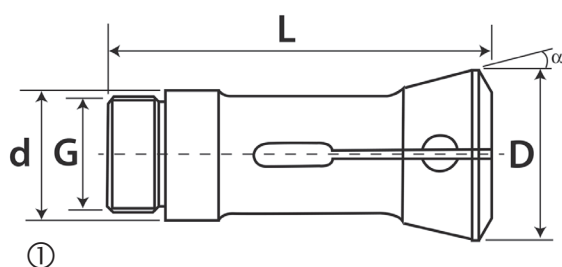

### GILDEMEISTER

Typ Type	passend für fits for	Abbildung Figure	d	D	L	Gewinde Threads	a (alpha)
9013E	AS12	1	26,8	34	88	M24 x 1,0 L	15°
9012E	AS16/20/GS/GM20	1	34	42,3	90	M30 x 1,0 L	16°
9017E	AS20 e. 25/GM20 erw.	2	38	45,5	90	M34,5 x 0,75 L	16°
9045E	AS25	2	45	60,4	164	M40 x 1,0 L	15°
9046E	GS25	2	45	60,4	164	M40 x 1,5 L	15°
9069E	AS/AV/GM32/GM35	2	53	69,4	139	M48 x 1,5 L	15°
9081E	GS35/36/42	2	56	72,4	137	M52 x 1,5 L	15°
9115E	GM42	2	64	80,5	134	M59 x 1,5 L	15°
9132E	AA/AR/AS/AV48	2	70	90,4	167,5	M65 x 1,5 L	15°
9178E	AS/AV67	2	90	115,4	183,5	M85 x 1,5 L	15°
9209E	AS82	2	109	138,4	201	M102 x 1,5 L	15°
9239E	AS100	2	128	160,4	263	M122 x 1,5 L	15°

## Mehrspindel-Spannzangen (Serie 9000) Multi-Spindle Collets (Series 9000)

Zum Spannen von Werkstücken in Mehrspindel-Stangenautomaten

For clamping of workpieces in multi-spindle automatic lathes

### INDEX

Typ Type	passend für fits for	Abbildung Figure	d	D	L	Gewinde Threads	a (alpha)
9007E	MS16	1	32	41,5	84	M28 x 1,0 L	15°
9033E	KS20/KS22	1	40	55,2	102	M35 x 1,5 R. o. L	15°
9039E	KS25/MS25	1	46	60,5	112	M40 x 1,5 L	16°
9070E	KS32	1	53	69,3	136	M47 x 1,5 L	15°
9108E	KS42	1	62	82,4	180	M58 x 1,5 L	15°
9133E	KS50	1	70	92	157	M65 x 2,0 L	15,5°

### SCHÜTTE

Typ Type	passend für fits for	Abbildung Figure	d	D	L	Gewinde Threads	a (alpha)
9015E	SF13	1	25	36,2	72	M22 x 1,0 L	15°
9007E	SE/SF16/SE18	1	32	41,5	84	M28 x 1,0 L	15°
9016E	SF20/VD20	1	32	41,5	84	M30 x 1,0 L	15°
9049E	SD/SE/VD25/AF/SE/SF26	1	46	60,3	120	M40 x 1,5 L	15°
9070E	AF/AV/SD/SF/VD32	1	53	69,3	136	M47 x 1,5 L	15°
9112E	SD/SF40/SF42	1	62,9	78,3	157	M56 x 1,5 L	15°
9139E	SD/VD50/AF/SF51	1	75	97,8	187	M68 x 1,5 L	15°
9179E	SD/VD63	1	90	115,8	211	M82 x 1,5 L	15°
9187E	AF/SF67	2	89,9	115,4	180	M85 x 1,5 L	15°
9210E	SD/VD80/AF/SF81	1	109	138,3	241	M100 x 1,5 L	15°

### TORNOS

Typ Type	passend für fits for	Abbildung Figure	d	D	L	Gewinde Threads	a (alpha)
9001E	AS14/BS14	2	25	35	75	M22 x 1	16°
9021E	AS16/SAS16	1	25	35	94	M25 x 1	15° 30'
9018E	BS20/22	1	35	45	107	M33 x 1	15° 30'
9020E	BS20	2	36	45	107	M33 x 1,25	15° 30'
9012E	Multi Deco 20-6/-8	1	34	42	90	M30 x 1 L	16°
9049E	Multi Deco 26-6	1	46	60,3	120	M40 x 1,5 L	15°
9081E	SAS36	2	56	72,4	139	M52 x 1,5 L	15°



## Mehrspindel-Vorschubzangen (Reihe 9000) Multi-Spindle Feed Fingers (Series 9000)

Zum Vorschub des Stangenmaterials in Mehrspindel-Stangenautomaten

For feeding bars in Multi-Spindle Automatic Lathes

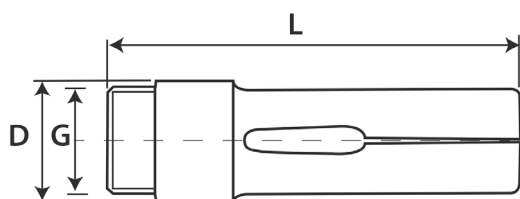

①

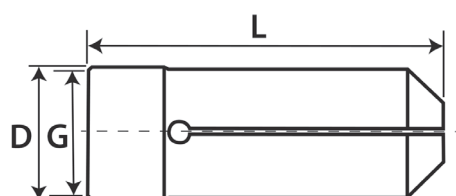

②



### GILDEMEISTER

Typ Type	passend für fits for	Abbildung Figure	d	D	L	Gewinde Threads
9259E	AS12	2	17,5	19,5	82	M17 x 1
9258E	AS16/AS20/GM20	1	25	25	90	M24 x 1
9288E	AS20 erw. 25	1	30	30,5	90	M28,5 x 0,75
9287E	AS25	1	32,5	33	140	M30 x 1 L
9289E	GS25	1	30	34,2	140	M30 x 1 L
9316E	AS32/AV32	1	39,8	40	136	M38 x 1,5 L
9335E	GM32 erw. 35/GM35	1	41	41,2	136	M39 x 1 L
9336E	GM32	1	40	41,2	136	M38 x 1,5 R. o. L
9333E	GS35	1	43,8	45	136	M42 x 1,5 L
9374E	GM42	1	50,2	51,5	136	M48 x 1,5
9368E	AA/AR/AS/AV48	1	56	57	136	M54 x 1,5 L
9447E	AS67	1	76	77,5	170	M74 x 1,5 L
9475E	AS/AV82	1	93	94	180	M88 x 1,5 L
9483E	AS100	1	113	114	235	M108 x 1,5 L

## Mehrspindel-Vorschubzangen (Reihe 9000) Multi-Spindle Feed Fingers (Series 9000)

Zum Vorschub des Stangenmaterials in Mehrspindel-Stangenautomaten

For feeding bars in Multi-Spindle Automatic Lathes

### INDEX

Typ Type	passend für fits for	Abbildung Figure	d	D	L	Gewinde Threads
9255E	MS16	1	23	25	88	M23 x 1
9273E	KS20/KS22	1	28	30,8	102	M28 x 1,5 R. o. L
9282E	KS25/MS25	1	33	37	118	M33 x 1,5
9319E	KS32	1	40	41,8	130	M38 x 1,5
9364E	KS42	1	50	54	170	M50 x 1,5 L
9402E	KS50	1	57	60	156	M57 x 2 L

### SCHÜTTE

Typ Type	passend für fits for	Abbildung Figure	d	D	L	Gewinde Threads
9261E	SF13	1	17	19,6	82	M18 x 1
9255E	SE16/SE18	1	23	25	88	M23 x 1
9262E	SF20/VD20	1	25	27	88	M25 x 1
9282E	SD/SE/VD25/AF/SE/SF26	1	33	35	118	M33 x 1,5
9319E	AF/AV/SD/SF/VD32	1	40	41,8	130	M38 x 1,5
9372E	SD/SF40/SF42	1	51	51	174	M48 x 1,5
9406E	SD/SF50/SF51	1	58	62	195	M58 x 1,5
9450E	SD/VD63	1	72	77	205	M72 x 1,5 L
9456E	AF/SF67	2	76	78	225	M75 x 1,5 L
9474E	SD/VD80/AF/SF81	1	90	92,8	233	M88 x 1,5 L

### TORNOS

Typ Type	passend für fits for	Abbildung Figure	d	D	L	Gewinde Threads
9251E	AS14/BS14	1	17,5	18	70	M16 x 0,75
9265E	AS16/SAS16	1	20,5	22,8	98	M20 x 0,75
9263E	BS20/BS22	1	29	29,7	116	M27 x 1
9266E	BS20	1	25,3	27,7	116	M25 x 1
9258E	Multi Deco 20-6/-8	1	30,5	30,5	90	M28 x 0,75
9282E	Multi Deco 26-6	1	33	35	118	M33 x 1,5

## Abgreifzangen/Synchronspannzangen für Einspindeldrehautomaten

## Pick-Up-Collets for Single-Spindle-Lathes

**Synchronspannzangen / Greiferzangen für Gegenspindel**  
Zum Abgreifen des Werkstücks zur Rückseitenbearbeitung

**Pick Up Collets for Counter Spindle**  
For pick up of workpieces and backworking

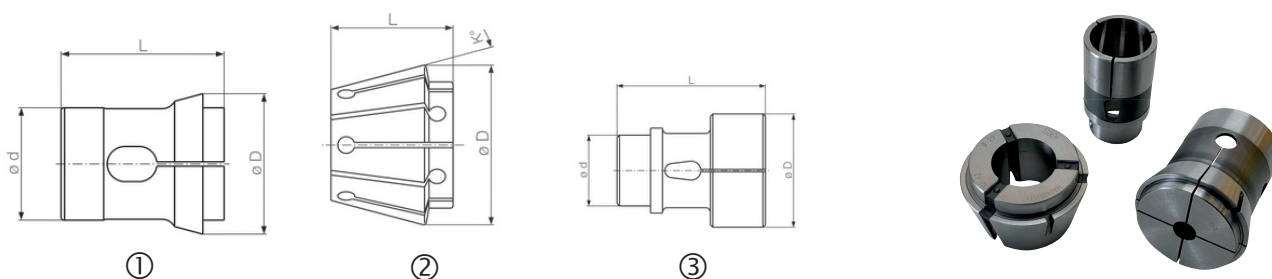

### INDEX

Typ Type	passend für fits for	Abbildung Figure	d	D	L
8831E	GB30	2		48,9	34
1462E	GB42	3		60,9	39
1444E	GS30/GSC30	3		36	62
1462E	GS42/GSC42/GB42/GB65	3		48	62
1463E	GE42/GE65	3		48	94
1465E	GS65	3		62	94
SZ42	ABC25/36/52	2		60,9	39

### TRAUB

Typ Type	passend für fits for	Abbildung Figure	d	D	L
1642E	TNM42/TNS30/42	1	46	55	65
1514E	TNS30/TNM28	1	35	40	46
3965E	TNS60/65D	1	71	85	79,5

## Abgreifzangen/Synchronspannzangen für Mehrspindeldrehautomaten

## Pick-Up-Collets for Multi-Spindle-Lathes

### Synchronspannzangen / Greiferzangen für Gegenspindel Zum Abgreifen des Werkstücks zur Rückseitenbearbeitung

### Pick Up Collets for Counter Spindle For pick up of workpieces and backworking

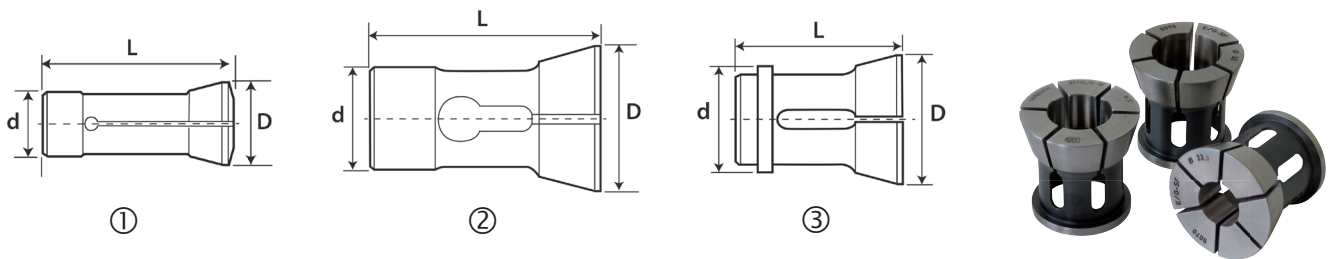

### INDEX

Typ Type	passend für fits for	Abbildung Figure	d	D	L	Gewinde Threads
9039E/SY	MS25	2	25	35,4	65	
9108E/G	KS32/42/50	2	36	49	71	M28 x 1,5L

### SCHÜTTE

Typ Type	passend für fits for	Abbildung Figure	d	D	L	Gewinde Threads
35161H/G	SG18/AG20		25	32,1	91,5	
9016E/G	SF20	3	28	36	50	M24 x 1,5L
9039E/G-SF	SF25/SF26/SE26/AF26/SC26/SCX26	3	34	42	53	
9070E/G-SF	SF32/AF32/SF42/AD40	3	52	60,6	60	
907034H/G	SF32/AF32/SF42/AD40	3	44	54	76	
9139E/G-SF	SD50/SF51/AF51	3	63	71,6	60	

### GILDEMEISTER

Typ Type	passend für fits for	Abbildung Figure	d	D	L	Gewinde Threads
9012E/G	GM20/GS20/AS16/AS20/AS25	1	26	26	80	M21,5 x 0,75
9069E/G	AS32/GS32/GM32	1	38	38	80	M24 x 1,5
90699H/G	AS32/GS32/GM32	1	39	39	82	

### TORNOS

Typ Type	passend für fits for	Abbildung Figure	d	D	L	Gewinde Threads
SYF16	AS14/AS16/SAS16/BS14/BS20/BS22	1	16	21	66	M14 x 0,75

### MORI SAY

Typ Type	passend für fits for	Abbildung Figure	d	D	L	Gewinde Threads
C0002800	SAY20	1	28	32	64	M24 x 1,5L
Q0003551	SAY32/TM626	1	35,5	40	80	Bayonett Ø27 x 2,7- 30°
Q0004700	SAY42	1	47	52,5	73	Bayonett Ø29 x 2,7- 30°

## Zugspannzangen DIN 6341 (Reihe 300)    Draw-In Collets DIN 6341 (Series 300)

Zum Spannen von Werkstücken in Teilapparaten, Schleifmaschinen oder Nachdrehbänken

For clamping of workpieces in indexing devices, grinding machines or second-operation lathes

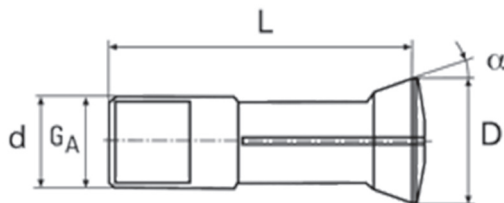



Typ Type	Bezeichnung description	Spannbereich clamping range	d	D	L	Gewinde Threads	a (alpha)
302E	B8 72-137	1,0 - 6,0	8	12,7	35	W6,85 x 40Gg	20°
314E	W10 80-1	1,0 - 10,0	10	14	43,7	M9,83x0,8333	15°
318E	W12 80-2	1,0 - 10,0	12	16	45,6	S11,75x1,25	15°
319E	K12	1,5 - 10,0	12	18	62,2	Tr12x1	20°
321E	W15 80-3	1,5 - 12,0	15	20,2	58,3	S14,75x1,25	20°
324E	B15 72-139	1,5 - 13,0	15	21,5	55,5	M13x1	20°
330E	K16	1,5 - 13,0	16	24	72,8	Tr16x1,5	20°
349E	W20 80-4	1,5 - 20,0	20	26,3	69	S19,7x1,666	15°
351E	K20	1,5 - 17,5	20	28	83	Tr20x1,5	20°
355E	L20 77-122	1,0 - 18,0	20	28	117,5	S19,7x2	17,5°
358E	B23	1,5 x 20,0	23	32	82	M21,2x1	20°
359E	K23	1,0 - 20,0	23	32	90	Tr23x1,5	20°
362E		3,0 - 22,0	25	34	89	M21,2x1	15°
363E	B25	1,5 - 22,0	25	33,5	85	M23x1	16°
364E	W25 80-5	1,5 - 22,0	25	33,7	92,5	S25x1	15°
366E		1,5 - 25,0	28	36	102	Tr27x1/20"	18°
367E	K28	1,5 - 24,0	28	38	100	Tr28x1,5	20°
369E	R8	2,0 - 22,0	24,12	31,75	101,5	7/16"x1/20"	8,5°
385E	5C/W31	1,0 - 26,0	31,8	37,5	83	31,45x1/20"	10°
386E	K32	1,0 - 29,0	32	45	110	Tr32x1,5	20°
3713E	B32 72-65	3,0 - 32,0	32	40	106	29,7x1,693	15°
B45	B45 72-199	4,0 - 45,0	45	53	115	M42x1,5	15°
389E	K45	5,0 - 40,0	45	60	140	Tr45x2	20°
390E		5,0 - 42,0	47	60	115	Tr47x1,5	20°



## Spannköpfe Clamping Heads



### Ausführungen



### Versions

	Verlängerte Version Long version	Kurze Version Short version	Ausdrehbare Version Soft version
			
<b>Verwendung Usage</b>	größere Kraftübertragung überwiegend für die Hauptspindel	für die Feinbearbeitung überwiegend auf der Gegenspindel	zur eigenen Formgebung der Bohrung
<b>Spannkopfgrößen Clamping Head sizes</b>	32 / 42 / 52 / 65 / 80 / 100	32 / 42 / 52 / 65 / 80 / 100	32 / 42 / 52 / 65 / 80 / 100
<b>Spannbereich in mm Clamping range</b>	4,0 bis max. Spannkopf	4,0 bis max. Spannkopf	5,0 bis max. Spannkopf
<b>Spannfläche Clamping bore</b>	Glatt Querrillen Längs- und Querrillen	Glatt Querrillen Längs- und Querrillen	weich - ausdrehbar
<b>Härte der Spannfläche Hardness of Clamping bore</b>	ca. 58 - 62 HRC	ca. 58 - 62 HRC	ca. 38 - 40 HRC
<b>Standard Profilbohrung Standard profile bore</b>	<ul style="list-style-type: none"> <li>● Rund</li> <li>⬡ 6-kant</li> <li>■ 4-kant</li> </ul>	<ul style="list-style-type: none"> <li>● Rund</li> <li>⬡ 6-kant</li> <li>■ 4-kant</li> </ul>	<ul style="list-style-type: none"> <li>● Rund</li> </ul>



## Spannköpfe Clamping Heads



Größe Size	Länge Length	Art Version	Schritt/ Step in mm	Profil Profile	Spannfläche Clamping bore	Spann Ø Clamping Ø	Bestell-Nr Order-No
32	44	kurze Version	1		Glatt	3,0 - 32,0 mm	SK32G030-320R
					Querrillen	8,0 - 10,0 mm	SK32080-100R
					Längs- und Querrillen	11,0 - 32,0 mm	SK32110-320R
					Glatt	7,0 - 27,0 mm	SK32G070-270S
					Querrillen	8,0 - 27,0 mm	SK32080-270S
						Glatt	7,0 - 22,0 mm
Querrillen	8,0 - 22,0 mm	SK32080-220V					



Größe Size	Länge Length	Art Version	Schritt/ Step in mm	Profil Profile	Spannfläche Clamping bore	Spann Ø Clamping Ø	Bestell-Nr Order-No
42	kurze Version: 42	kurze Version Glatt	0,5		Glatt	3,0 - 42,0 mm	SK42G030-420R
					Querrillen	8,0 - 10,5 mm	SK42080-105R
					Längs- und Querrillen	11,0 - 42,0 mm	SK42110-420R
	lange Version: 47	lange Version mit Rillen	1		Glatt	7,0 - 38,0 mm	SK42G070-380S
					Querrillen	8,0 - 38,0 mm	SK42080-380S
			1		Glatt	7,0 - 28,0 mm	SK42G070-280V
Querrillen	8,0 - 28,0 mm	SK42080-280V					

Größe Size	Länge Length	Art Version	Schritt/ Step in mm	Profil Profile	Spannfläche Clamping bore	Spann Ø Clamping Ø	Bestell-Nr Order-No
52	46	kurze Version	0,5		Glatt	3,0 - 52,0 mm	SK52G030-520R
					Querrillen	8,0 - 10,5 mm	SK52080-105R
					Längs- und Querrillen	11,0 - 52,0 mm	SK52110-520R
			1		Glatt	7,00 - 45,0 mm	SK52G070-450S
					Querrillen	8,0 - 45,0 mm	SK52080-450S
			1		Glatt	7,0 - 36,0 mm	SK52G070-360V
Querrillen	8,0 - 36,0 mm	SK52080-360V					

## Spannköpfe Clamping Heads

Größe Size	Länge Length	Art Version	Schritt/ Step in mm	Profil Profile	Spannfläche Clamping bore	Spann Ø Clamping Ø	Bestell-Nr Order-No
65	kurze Version: 53	kurze Version mit Rillen	0,5		Glatt	4,0 - 65,0 mm	SK65G040-650R
					Querrillen	8,0 - 10,5 mm	SK65080-105R
					Längs- und Querrillen	11,0 - 65,0 mm	SK65110-650R
	lange Version: 58	lange Version mit Rillen	1		Glatt	7,0 - 56,0 mm	SK65G070-560S
					Querrillen	8,0 - 56,0 mm	SK65080-560S
					1		Glatt
Querrillen	8,0 - 46,0 mm	SK65080-460V					

Größe Size	Länge Length	Art Version	Schritt/ Step in mm	Profil Profile	Spannfläche Clamping bore	Spann Ø Clamping Ø	Bestell-Nr Order-No
80	53	kurze Version	1		Glatt	5,0 - 80,0 mm	SK80G050-800R
					Querrillen	8,0 - 10,0 mm	SK80080-100R
					Längs- und Querrillen	11,0 - 80,0 mm	SK80110-800R
			1		Glatt	7,0 - 68,0 mm	SK80G070-680S
					Querrillen	8,0 - 68,0 mm	SK80080-680S
					1		Glatt
Querrillen	8,0 - 56,0 mm	SK80080-560V					







Größe Size	Länge Length	Art Version	Schritt/ Step in mm	Profil Profile	Spannfläche Clamping bore	Spann Ø Clamping Ø	Bestell-Nr Order-No
100	59	kurze Version	1		Glatt	15,0 - 100,0 mm	SK100G150-1000R
					Querrillen	15,0 - 24,0 mm	SK100150-240R
					Längs- und Querrillen	25,0 - 100,0 mm	SK100250-1000R
					Querrillen	50,0 - 86,0 mm	SK100500-860S
						Querrillen	50,0 - 70,0 mm



## Spannköpfe Clamping Heads

### Weiche Spannköpfe - zum Ausdrehen

### Soft Clamping Heads - to turn out

Größe Size	Länge Length	Art Version	Profil Profile	Spannfläche Clamping bore	Spann Ø Clamping Ø	Bestell-Nr Order-No
32	44,0	Stirnfläche und Bohrung weich		Glatt	5,0 mm	SK32W050R
					10,0 mm	SK32W100R
					20,0 mm	SK32W200R
42	42,0	Stirnfläche und Bohrung weich		Glatt	5,0 mm	SK42W050R
					15,0 mm	SK42W150R
					30,0 mm	SK42W300R
52	46,0	Stirnfläche und Bohrung weich		Glatt	5,0 mm	SK52W050R
					15,0 mm	SK52W150R
					30,0 mm	SK52W300R
65	53,0	Stirnfläche und Bohrung weich		Glatt	5,0 mm	SK65W050R
					10,0 mm	SK65W100R
					20,0 mm	SK65W200R
					40,0 mm	SK65W400R
80	53,0	Stirnfläche und Bohrung weich		Glatt	8,0 mm	SK80W080R
					20,0 mm	SK80W200R
					40,0 mm	SK80W400R
					60,0 mm	SK80W600R
100	59,0	Stirnfläche und Bohrung weich		Glatt	30,0 mm	SK100W300R
					45,0 mm	SK100W450R
					65,0 mm	SK100W650R
					90,0 mm	SK100W900R

### Sonderleistungen

### Special Services

Zwischenmaße special measures	beginnend bei 3,0 mm bis 80,0 mm from 3,0 mm to 80,0 mm
Hartmetallbeschichtung (82 HRC) carbide-coated (82 HRC)	die echte Alternative zu SUPERGRIP the alternative to SUPERGRIP
Profile nach Kundenwunsch special shape	Fertigung nach Kundenwunsch und Kundenplan manufactured to customer requirements

## Spannköpfe Clamping Heads

### Wechselvorrichtung manuell

### Changing Device

Größe Size		Bestell-Nr Order-No
32		WV32
42		WV42
52		WV52
65		WV65
80		WV80

Wir führen auch sämtliche Spannköpfe für Mehrspindel-Drehautomaten

We can also offer all Clamping Heads for Multi-Spindle Automatic Lathes

**Fragen Sie uns einfach!**  
Just ask us!



## Führungsbüchse mit HM-Einsatz    Guide Bushes with Carbide Insert

**Verstellbare Führungsbüchsen**  
mit Hartmetalleinsatz für Langdrehautomaten

**Adjustable Guide Bushes**  
With carbide insert for swiss automatic lathes

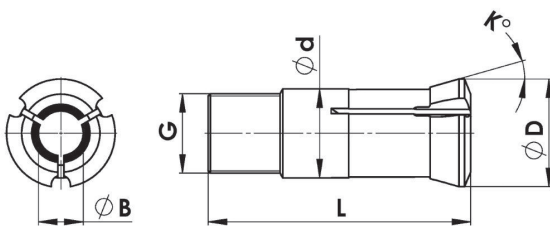

Typ Type	EURO codes	US codes	d	D	G	L	K	B
F103	B211		12	16	M12 x 1	50	30°	1,0 - 7,5
F104	B208		20	24	M20 x 1	55	30°	2,0 - 13,0
F105	61.001/B207		40	48	M40 x 1	71	30°	3,0 - 26,0
F3001	T11-53-n10.075/3.001/74	TD7	11	14,5	M10x0,75	53	16°	1,0 - 7,0
F351	51.001/J3		9	13	M8 x 0,6	50	30°	0,7 - 5,5
F352			11	15	M10 x 0,6	50	30°	1,0 - 7,5
F355	T32-71/282.001/3214	TSD20	32	38,8	M32x1	71	30°	3,0 - 22,0
F391	T22-68-M22.1 / 39.001 / J7AR	TD20R	22	29	M22 x 1	68	16°	3,0 - 18,0
F605	T24-61 / 61.002 / B238	0201	24	29,5	M24 x 1	61	30°	2,0 - 17,0
F850			16	20	M16 x 1	52	30°	1,0 - 12,0
F853	T18-59-M16.1 / 166.001 / B212A		18	21,8	M16 x 1	59	30°	1,0 - 13,0
F854	172.001/B207A		40	48	M36 x 1	71	30°	3,0 - 26,0
I 351	T9-44 / 51.001 / J3	PD4	9	12,5	M8 x 0,75	44	16°	1,0 - 6,0
I 352	T11-53-M10.080		11	14,5	M10x0,8	53	16°	1,0 - 7,5
I 353	T16-59 / 8.001 / J6R	TD10	16	20,5	M14 x 1	59	16°	1,0 - 12,0
I 354	T22-68-M19,1/13.001/J7A	TD20	22	29	M19x1	68	16°	2,0 - 16,0
I357	T28-81 / 18.001 / B260	TD25	28	38	M25 x 1	81	30°	3,0 - 21,0
T221	T21-75.4 / 450.001 / B301	SNC15	21	24	M18 x 1	57,5	12°	3,0 - 15,0
T223	T28-82-M25.1 / 22.001 / B261	TD25S	28	34	M25 x 1	82	16°	3,0 - 21,0
T223S	erw. Durchlass / spindle expansion		28	34	M27 x 1	82	16°	21,0 - 23,0
T227	T34-87.5 / 451.001 / B227	CD25	34	41	M34 x 1	87,5	10°	3,0 - 26,0
T229	T42-82-C16 / 28.001 / J9	TD32S	42	49	M40 x 1	82	16°	3,0 - 32,0
T229S	erw. Durchlass / spindle expansion		42	49	M42 x 1	82	16°	30,0 - 36,0
T248	T48-82 / 464.001	STM38	48	54	M46 x 1	82	16°	2,0 - 38,0
T330	11.001		14	18	M13 x 0,75	63	16°	2,0 - 9,0
T340	113.001		13	16	M12,5 x 0,75	41,5	15°	1,0 - 8,0
TD26	T26-77/99,001	TD26	26	29	M25x1	77	16°	2,0 - 20,0

**Auch erhältlich:**

Zwischenmaße  
verlängerter HM-Einsatz (30 mm / 40 mm)  
Sechskant Vierkant Führungsbüchsen  
UP Rundlaufgenauigkeit  
weitere Typen auf Anfrage  
kaltvulkanisieren der Scheitze

**Also available:**

intermediate sizes  
extended carbide length (30 mm / 40 mm)  
hexagon square guide bushes  
UP runout accuracy  
more types on request  
vulcanizing of slots

## Spannhülsenlagerungen Revolving Ends

für FMB, IEMCA, BREUNING IRCO, TRAUB Lademagazine / Bar Loaders

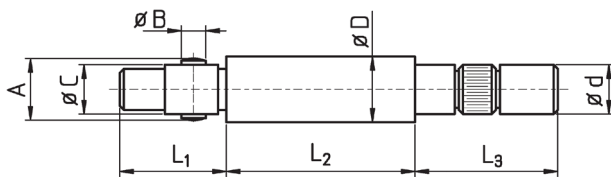

Typ Type	d	D	A	B	C	L <sub>1</sub>	L <sub>2</sub>	L <sub>3</sub>
SHLGD10	8	10,3	9,8	4	7	27	43	31
SHLGD12	8	12	11,8	4	8	27	43	31
SHLGD15	12	15	14,8	6	11	26	44	31
SHLGD16	12	16	15,8	6	11	26	44	31
SHLGD18	12	18	17,8	6	11	26	44	31
SHLGD20	17	20	19,8	8	14	39	47	31
SHLGD22	17	22	21,8	8	14	39	47	31
SHLGD25	20	25	24,8	8	20	42	47	31
SHLGD28	20	28	24,8	8	20	42	47	31
SHLGD30	20	30	29,8	8	20	42	47	31
SHLGD32	20	32	31,8	8	20	42	47	30
SHLGD36	20	36	35,8	8	20	42	47	30

für LNS Mini-Sprint S2

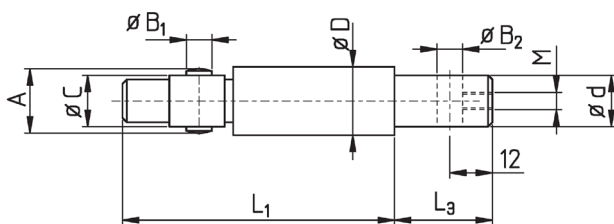

Typ Type	d	D	A	B <sub>1</sub> / B <sub>2</sub>	C	L <sub>1</sub>	L <sub>3</sub>	M
SHLGL10	8	10	10	4	7	65	30	M4
SHLGL12	8	12	12	4	8	65	30	--
SHLGL15	12	15	15	6	11	66	30	M5
SHLGL18	12	18	18	6	11	66	30	--
SHLGL20	17	20	20	8	14	81	30	M8
SHLGL25	20	25	25	8	20	85,5	30	M8
SHLGL36	30	36	36	8 / --	20	158	40	--

## Spannhülsenlagerungen    Revolving Ends

für FMB, LNS, BREUNING IRCO Lademagazine / Bar Loaders

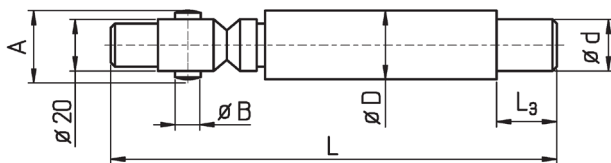

Typ Type	d	D	A	B	L <sub>3</sub>	L
SHLGTD25 *	20	25	24,8	8	40	197
SHLGTD28 *	25	28	25,8	8	40	197
SHLGTD30 *	25	30	25,8	8	40	197
SHLGTD32 *	25	32	31	8	40	197
SHLGTD34 *	30	34	31	8	40	197
SHLGTD36 *	30	36	35	8	40	207
SHLGTD38	30	38	-	-	40	207
SHLGTD40	33	40	-	-	50	207
SHLGTD42	33	42	-	-	50	207
SHLGTD45	33	45	-	-	50	207
SHLGTD50	42	50	-	-	50	207
SHLGTD60	51	60	-	-	75	232
SHLGTD63 **	51	63	-	-	75	232
SHLGTD65 **	51	65	-	-	75	232

\* Verwendbar für Spannhülsen „Turbo“ und mit Querstift / \* Useable for Bar Feeder Collets „Turbo“ and pinned type

\*\* Auf Anfrage / \*\* On request

für TORNOS Lademagazine / Bar Loaders

Typ Type	d	D	A	B	L <sub>3</sub>	L
SHLGTO32	22	32	31	8	30	192
SHLGTO36	25	36	35	8	30	192

## Spannhülslagerungen Revolving Ends

### für TORNOS, ROBOBAR Lademagazine / Bar Loaders

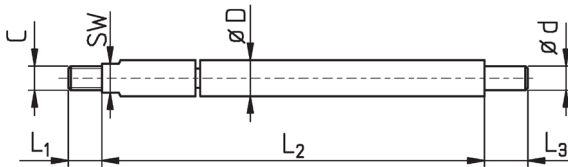

Typ Type	d	D	A	B	C	L <sub>1</sub>	L <sub>2</sub>	L <sub>3</sub>
SHLGR05	M3	5,5	-	-	M4	7	78	8
SHLGR07	M5	7,5	-	-	M5	7	78	16

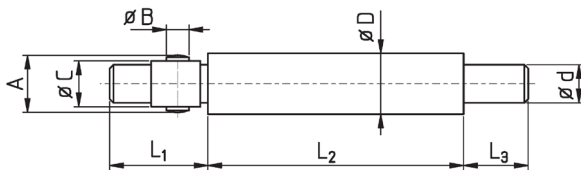

Typ Type	d	D	A	B	C	L <sub>1</sub>	L <sub>2</sub>	L <sub>3</sub>
SHLGR10	7	10,5	9,8	4	7	25	73	16
SHLGR12	8	12	11,8	4	8	26	73	16
SHLGR16	10	16	14,8	6	11	28	116	16
SHLGR18	10	18	14,8	6	11	28	116	16
SHLGR21	14	20,5	19,8	8	14	40	110	20
SHLGR25	20	25	24,8	8	20	43	114	22
SHLGR26	20	26	24,8	8	20	43	114	22

### für IEMCA, CUCCHI Lademagazine / Bar Loaders

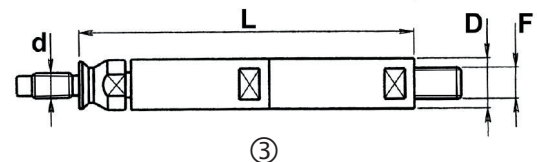
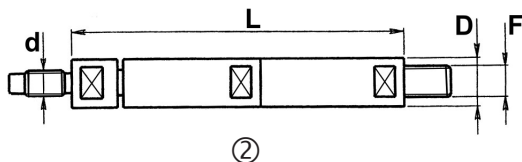

Typ Type	D	L	F	d	Abbildung Figure
Ch517120	19	100	M17x1,5li	M10x1,5li	2
Ch517120P	19	100	M17x1,5li	M14x1,5li	2
Ch517125	24	100	M20x1,5li	M14x1,5li	2
Ch517125P	24	100	M20x1,5li	M20x1,5li	2
Ch517130	29,3	121	M26x1,5li	M18x1,5li	2
Ch517130S	29,3	121	M26x1,5li	M18x1,5li	3
Ch517130P	29,3	121	M26x1,5li	M26x1,5li	2
Ch517138	38	109	M30x1,5li	M25x1,5li	2
Ch517138P	38	109	M30x1,5li	M30x1,5li	2

## Spannhülslagerungen Revolving Ends

für BECHLER, TORNOS Lademagazine / Bar Loaders

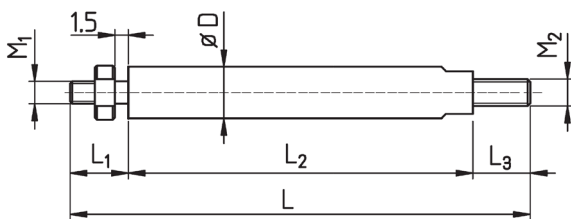

Typ Type	D	M <sub>1</sub>	M <sub>2</sub>	L <sub>1</sub>	L <sub>2</sub>	L <sub>3</sub>	L	Magazin Magazine
SHLGB07	7	M4	M5	11,5	42	10	63,5	BECHLER
SHLGB10	10	M5	M6	14	68	14	96	BECHLER
SHLGB10-2	10	M5	M6	14	56	14	84	BECHLER
SHLGT0045	4,5	M3	M3 IG	5		--	62	TORNOS
SHLGT0055	5,5	M3	M3 IG	8	55	--	63	TORNOS
SHLGT007	7	M4	M5	12	42	10	64	TORNOS
SHLGT0075	7,5	M4	M5	11,5	42	10,5	64	TORNOS
SHLGT0085	8,5	M5	M5	12	41,5	10	63,5	TORNOS
SHLGT0105	10,5	M6	M6	14	45	11	70	TORNOS

für GAUTHIER, IEMCA, LNS Lademagazine / Bar Loaders

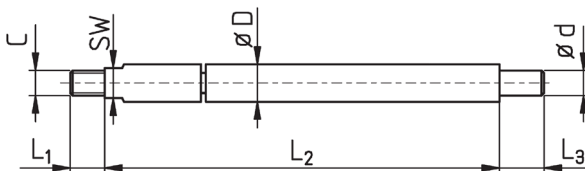

Typ Type	D	M <sub>1</sub>	M <sub>2</sub>	S/W	L <sub>1</sub>	L <sub>2</sub>	L <sub>3</sub>		Magazin Magazine
SHLGG05	5,0	M4	M4	4	7	73	11		GAUTHIER/IEMCA
SHLGG055	5,5	M4	M4	4	7	73	11	*	GAUTHIER/IEMCA
SHLGG07	7,0	M5	M5	6	7	79	11		GAUTHIER
SHLGG075	7,5	M5	M5	6	7	79	11	*	GAUTHIER
SHLGM07	7,0	M4	M5	6	8	115	11		LNS Mini Sp
SHLGM075	7,5	M4	M5	6	8	115	11	*	LNS Mini Sp
SHLGM12	12	M6	M6	9					LNS Mini Sp

\* Standardausführung für Kanal D5 bzw. D7 / \* Standard version for channel D5 resp. D7

## Spannhülsenlagerungen Revolving Ends

### für TRAUB, FMB Lademagazine / Bar Loaders

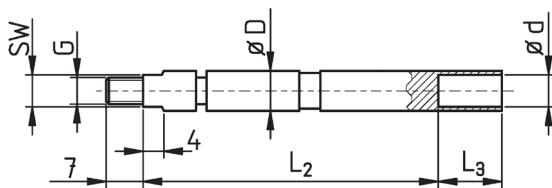

Typ Type	D	G	d	SW	L <sub>2</sub>	L <sub>3</sub>	Magazin Magazine
SHLGT05	5,5	M4	4,5	4	56	12	TRAUB/FMB
SHLGT07	7,5	M5	6,5	6	63	15	TRAUB/FMB

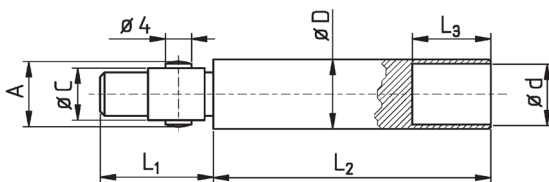

Typ Type	D	A	C	d	L <sub>1</sub>	L <sub>2</sub>	L <sub>3</sub>	Magazin Magazine
SHLGT10	10	9,9	7	9	24	63,5	18	TRAUB
SHLGT12	12	11,9	8	11	24	63,5	18	TRAUB

### für IEMCA Lademagazine / Bar Loaders

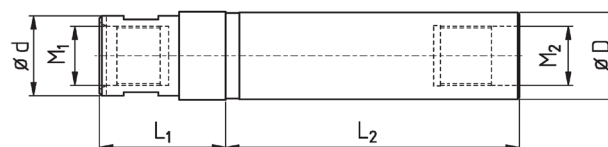

Typ Type	D	d	L <sub>1</sub>	L <sub>2</sub>	M <sub>1</sub>	M <sub>2</sub>
SHLGI25	25	23	40	81	M17x1	M17x1
SHLGI30	30	30	49	91	M25x1,5	M20x1
SHLGI40	40	45	51	114	M25x1,5	Ø30



## Spannhülsenlagerungen Revolving Ends

### für IEMCA, BOSS Lademagazine / Bar Loaders

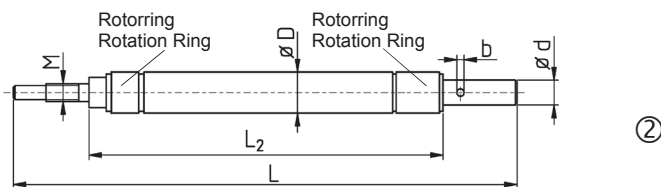
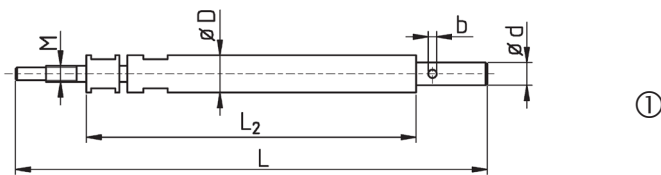

Typ Type	D	d	L <sub>2</sub>	L	M	b	Abbildung Figure	
SHLGI12	12	8	109	172	M7x0,75	3	1	Für Spannhülsen DI original IEMCA
SHLGI15	15	12	132,5	195	M8x1	4	2	
SHLGI16	16	12	132,5	195	M8x1	4	2	For Bar Feed Collets original IEMCA
SHLGI18	18	12	132,5	195	M8x1	4	2	
SHLGI20	20	14	132,5	210	M10x1	-	2	
SHLGI23	23	14	132,5	210	M10x1	4	2	

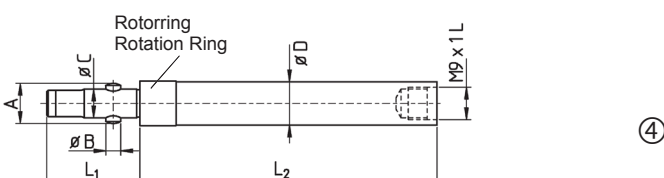
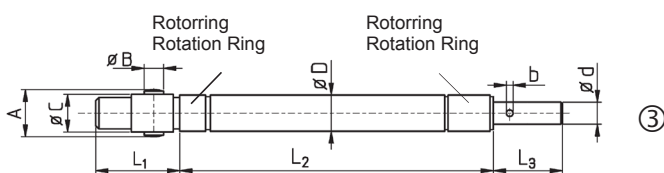

Typ Type	D	d	L <sub>1</sub>	L <sub>2</sub>	L <sub>3</sub>	A	B	C	b	Abbildung Figure	
SHLGJ12	12	8	27	113	30	12	4	8	3	3	Für Spannhülsen mit Querloch
SHLGJ12-2	12	--	26	83	--	12	4	8	--	4	
SHLGJ15	15	12	26	127	35	15	6	11	4	3	For Bar Feed Collets pinned type
SHLGJ16	16	12	26	127	35	16	6	11	4	3	
SHLGJ18	18	12	26	127	35	18	6	11	4	3	
SHLGJ20	20	14	37	126	33	20	8	14	-	3	

## Spannhülsen für Lademagazine Bar Feed Collets for Bar Loaders

für FMB, IEMCA, LNS, TRAUB, TORNOS

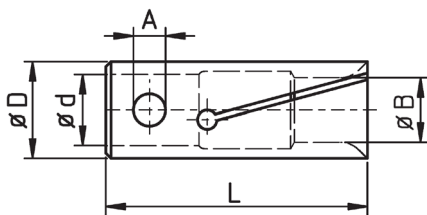

mit Querbefestigung  
Pinned type



Typ Type	D	G/d	A	L	B min.	B max.	stg. step
SHD05	5	M4	-	37	0,8	4,5	0,1
SHD07	7	M5	-	37	0,6	6,0	0,1

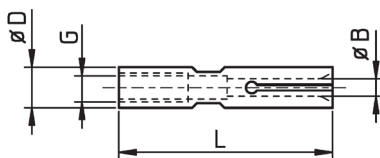

mit Gewinde  
with Thread



Typ Type	D	G/d	A	L	B min.	B max.	stg. step
SHD10	10	7	4	40	1,0	9,0	0,5
SHD12	12	8	4	40	1,5	10,5	0,5
SHD15	15	11	6	40	2,0	13,5	0,5
SHD16	16	11	6	40	4,0	15,0	0,5
SHD18	18	11	6	40	3,0	17,0	0,5
SHD20	20	14	8	65	2,0	19,0	0,5
SHD22	22	14	8	65	4,0	21,0	0,5
SHD25	25	20	8	65	2,0	24,0	0,5
SHD28	28	20	8	65	3,0	27,0	0,5
SHD30	30	20	8	65	4,0	29,0	0,5
SHD32	32	20	8	65	3,0	31,0	0,5
SHD34	34	20	8	65	28,0	33,0	0,5
SHD36	36	20	8	65	4,0	35,0	0,5

Dünnwandige Spannhülsen auch als „Longlife“ lieferbar  
Zollmaße bis 1/16“-stg. ohne Aufpreis

Thin-walled Bar Feeder Collets also available in „Longlife“-type  
Imperial sizes up to 1/16“-step without extra charge

## Spannhülsen für Lademagazine Bar Feed Collets for Bar Loaders

für BECHLER, LNS, TRAUB, TORNOS

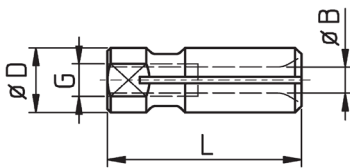

Typ Type	D	G	L	B min.	B max.	stg. step
SHB07	7	M5	26	1,0	6,3	0,1
SHB10	10	M5	26	1,5	8,5	0,1

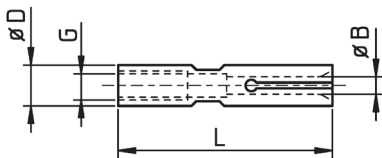

Typ Type	D	G	L	B min.	B max.	stg. step
SHL06	6	M4	30	0,6	5,0	0,1
SHL07	7	M4	30	1,0	6,0	0,1
SHL10	11	M5	30	1,5	9,0	0,1
SHL12	12	M6	30	2,0	11,0	0,5
SHL125	12,5	M6	30	8,0	12,0	0,5

Dünnwandige Spannhülsen auch als „Longlife“ lieferbar

Thin-walled Bar Feeder Collets also available in „Longlife“-type

## Spannhülsen für Turbo-Lademagazine

## Bar Feed Collets for Turbo Bar Loaders

für FMB, BREUNING IRCO, LNS, TORNOS

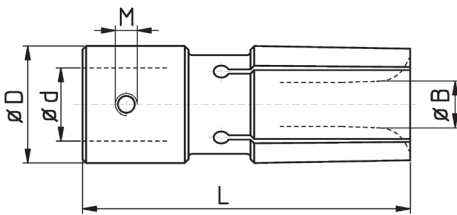

Typ Type	D	d	L	M	B min.	B max.	stg. step
SHTD25	25	20	90	M5	2,5	24,0	0,5
SHTD28	28	20	90	M5	5,0	26,0	0,5
SHTD30	30	20	90	M6	3,0	28,0	0,5
SHTD32	32	20	90	M6	2,5	30,5	0,5
SHTD34	34	20	90	M6	6,0	32,5	1,0
SHTD36	36	20	90	M8	4,0	34,0	0,5
SHTD38	38	20	90	M8	10,0	36,0	0,5
SHTD40	40	20	90	M8	7,0	38,5	1,0
SHTD42	42	20	90	M8	3,0	40,0	1,0
SHTD50	50	20	90	M8	6,0	48,5	1,0
SHTD54	54	20	90	M8	20,0	51,0	1,0
SHTD55	55	20	90	M8	20,0	52,0	1,0
SHTD58	58	20	90	M8	20,0	55,0	1,0
SHTD60	60	20	90	M8	10,0	58,5	1,0
SHTD63	63	20	90	M8	10,0	61,5	1,0
SHTD65	65	20	90	M8	8,0	63,5	1,0

Dünnwandige Spannhülsen auch als „Longlife“ lieferbar  
 Zollmaße bis 1/16“-stg. ohne Aufpreis  
 Alle Spannhülsen auch als XT-Ausführung (definierte Spannkraft) lieferbar

Thin-walled Bar Feeder Collets also available in „Longlife“-type  
 Imperial sizes up to 1/16“-step without extra charge  
 All Bar Feed Collets also available in XT-type (defined clamping force)

## Spannhülsen Bar Feed Collets

### für TOP AUTOMAZIONI

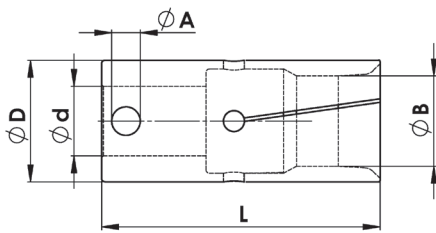

Typ Type	D	d	L	A	B min.	B max.	stg. step
SHTA20	20	14	80	5	3,0	17,5	0,5
SHTA25	25	14	80	5	16,0	22,0	0,5
SHTA30	30	20	80	8	21,0	27,5	0,5
SHTA32	32	20	80	8	26,0	29,0	0,5
SHTA35	35	20	80	8	26,0	32,0	0,5
SHTA40	40	20	80	8	31,0	38,0	0,5
SHTA42	42	20	80	8	36,0	40,0	0,5
SHTA45	45	20	80	8	36,0	42,0	0,5
SHTA50	50	20	80	8	41,0	47,0	0,5
SHTA55	55	20	80	8	46,0	52,0	1,0
SHTA60	60	20	80	8	51,0	56,0	1,0
SHTA65	65	20	80	8	56,0	62,0	1,0

### für TOP AUTOMAZIONI Sonderlösungen / Special Solutions

Typ Type	D	d	L	A	B min.	B max.	stg. step
SSHTA20	20	14	80	5	17,0	19,0	0,5
SSHTA25	25	14	80	5	21,7	24,0	0,5
SSHTA30	30	20	80	8	27,0	29,0	0,5
SSHTA32	32	20	80	8	29,0	31,0	0,5
SSHTA35	35	20	80	8	31,5	34,0	0,5
SSHTA40	40	20	80	8	37,0	39,0	0,5
SSHTA42	42	20	80	8	37,0	41,0	0,5
SSHTA45	45	20	80	8	42,0	44,0	0,5
SSHTA50	50	20	80	8	47,0	49,0	0,5
SSHTA51	51	20	80	8	49,0	50,0	0,5
SSHTA52	52	20	80	8	47,0	51,0	0,5
SSHTA55	55	20	80	8	52,5	54,0	0,5
SSHTA60	60	20	80	8	57,0	59,0	0,5
SSHTA65	65	20	80	8	62,5	64,0	0,5

Dünnwandige Spannhülsen auch als „Longlife“ lieferbar

Thin-walled Bar Feeder Collets also available in „Longlife“-type

## Spannhülsen für Lademagazine Bar Feed Collets for Bar Loaders

für IEMCA mit Aufschraubgewinde / with Right Hand Thread

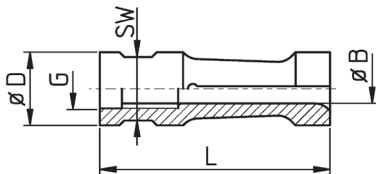

Typ Type	D	G	L	SW	B min.	B max.	stg. step
SHI07	7,5	M5x0,5	40	6	1,5	6,5	0,1
SHI10	10	M6x0,75	40	8	1,5	9,0	0,1
SHI12	12	M7x0,75	42	10	1,6	10,5	0,1
SHI15	15	M8x1	42	13	3,0	13,0	0,1
SHI16	16	M8x1	42	14	6,0	15,0	0,5
SHI18	18	M8x1	42	14	11,0	16,5	0,5
SHI20	20	M10x1	59	17	2,5	18,5	0,1
SHI23	23	M10x1	59	19	11,0	21,0	0,5
SHI25	25	M10x1	59	22	8,0	23,0	0,5
SHI27	27	M10x1	59	22	16,0	25,5	0,5
SHI30	30	M10x1 *	65	28	6,0	28,0	0,5
SHI31 **	31	M10x1 *	65	28	8,0	29,0	0,5
SHI32	32	M10x1 *	65	28	6,0	30,0	0,5
SHI33	33	M10x1 *	65	28	8,0	32,0	0,5
SHI34	34	M25x1,5	65	28	5,0	32,0	0,5
SHI35	35	M25x1,5	65	30	19,0	33,0	0,5

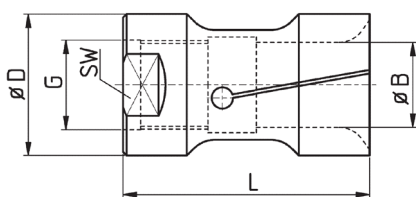

Typ Type	D	G	L	SW	B min.	B max.	stg. step
SHI36	36	M25x1,5	65	34	20,0	34,0	0,5
SHI40	40	M25x1,5	70	36	10,0	37,0	0,5
SHI42	42	M25x1,5	70	36	20,0	40,0	0,5
SHI46	46	M25x1,5	72	40	20,0	44,0	0,5
SHI50	50	M25x1,5	80	46	43,0	48,0	0,5
SHI52	52	M25x1,5	80	50	45,0	50,0	0,5
SHI54	54	M25x1,5	80	50	47,0	52,0	0,5
SHI55	55	M25x1,5	80	50	20,0	54,0	0,5
SHI56	56	M25x1,5	80	50	20,0	54,0	0,5
SHI58	58	M25x1,5	80	50	20,0	54,0	0,5
SHI60	60	M25x1,5	80	55	20,0	57,0	0,5
SHI65	65	M25x1,5	80	55	56,0	63,0	0,5

\*Auch mit folgenden Gewinden lieferbar:

\*\*Also available with threads:

M17x1 ; M25x1,5 ; M18x1,5 ; M18x1,5L

Dünnwandige Spannhülsen auch als „Longlife“ lieferbar

\*\*Auch für Stama-Magazine

Thin-walled Bar Feeder Collets also available in „Longlife“-type

\*\*Also for Stama loaders

## Spannhülsen für Lademagazine Bar Feed Collets for Bar Loaders

für P. CUCCHI mit Aufschraubgewinde links / with Left Hand Thread

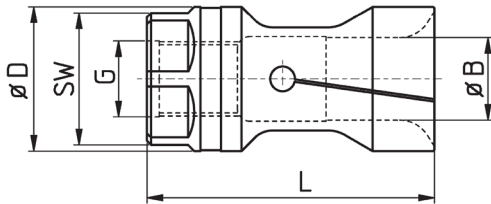

Typ Type	D	G	L	SW	B min.	B max.	stg. step	Magazin Magazine
SHC19	19	M10x1L	60	17	4,0	17	0,1	CUCCHI PB20
SHC20	20	M10x1L	60	17	8,0	18,5	0,1	CUCCHI PB20
SHC23	23	M14x1L	60	21	4,0	21,0	0,5	CUCCHI PB23
SHC24	24	M14x1L	60	22	21,0	22,0	0,5	CUCCHI PB24
SHC25	25	M14x1L	60	22	6,0	23,5	0,5	CUCCHI PB24
SHC28	28	M18x1,5L	65	24	21,0	24	0,5	CUCCHI PB28
SHC29	29	M18x1,5L	65	27	5,0	27,5	0,5	CUCCHI PB30
SHC30	30	M18x1,5L	65	28	18,0	28	0,5	CUCCHI PB30
SHC32	32	M18x1,5L	65	28	20,0	30,0	0,5	CUCCHI PB32
SHC33	33	M18x1,5L	70	30	25,0	31,0	0,5	CUCCHI PB35A
SHC34	34	M18x1,5L	70	30	8,0	32,5	0,5	CUCCHI PB35A
SHC35	35	M18x1,5L	70	32	10,0	33,0	0,5	CUCCHI PB35
SHC37	37	M25x1,5L	70	32	10,0	35,0	0,5	CUCCHI PB38
SHC38	37,8	M25x1,5L	70	32	30,0	36,0	0,5	CUCCHI PB38
SHC39	39	M25x1,5L	70	36	16,0	37,0	0,5	CUCCHI PB38
SHC40	39,8	M25x1,5L	70	36	20,0	38,0	0,5	CUCCHI PB42
SHC41	41	M25x1,5L	70	36	19,0	40,0	0,5	CUCCHI PB42
SHC42	42	M25x1,5L	70	36	20,0	40,0	0,5	CUCCHI PB42
SHC43	42,8	M25x1,5L	70	36	20,0	41,0	0,5	CUCCHI PB42
SHC44	44	M25x1,5L	70	36	20,0	42,0	0,5	CUCCHI PB42
SHC47	47	M30x1,5L	70	40	10,0	45,0	0,5	CUCCHI PB48
SHC50	49,7	M30x1,5L	70	50	20,0	48,0	0,5	CUCCHI PB
SHC55	55	M30x1,5L	80	50	20,0	53,0	0,5	CUCCHI PB
SHC60	59 (59,7)	M30x1,5L	80	56	19,0	58,0	0,5	CUCCHI PB60
SHC65	65	M30x1,5L	80	60	58,0	62,0	0,5	CUCCHI PB68

Dünnwandige Spannhülsen auch als „Longlife“ lieferbar

Thin-walled Bar Feeder Collets also available in „Longlife“-type

## ER-Spannzangen ER-Collets

### ER-Spannzangen

Standard, zum Spannen von Werkzeugen mit zylindrischem Schaft

### ER-Collets

Standard, for clamping of tools with cylindrical shank

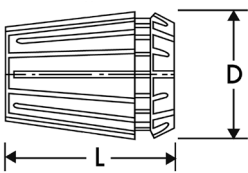

Typ Type	Spannbereich Clamping Range	Steigung	D	L
ER08	1,0 - 5,0	0,5	8,5	13
ER11	1,0 - 8,0	0,5	11,5	18
ER16	1,0 - 12,0	0,5	17	27,5
ER20	1,0 - 16,0	0,5	21	31,5
ER25	1,0 - 20,0	0,5	26	34
ER32	1,0 - 25,0	0,5	33	40
ER40	1,0 - 32,0	1	41	46
ER50	6,0 - 40,0	2	52	60

## ERC-Spannzangen ERC-Collets

### ERC-Spannzangen

Abgedichtet, zum Spannen von Werkzeugen mit zylindrischem Schaft

### ERC-Collets

Sealed, for clamping of tools with cylindrical shank

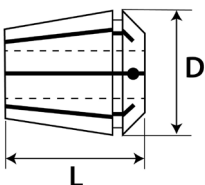

Typ Type	Spannbereich Clamping Range	Steigung	D	L
ERC11	3,0 - 6,0	1	11,5	18
ERC16	3,0 - 10,0	1	17	27,5
ERC20	3,0 - 13,0	1	21	31,5
ERC25	3,0 - 16,0	1	26	34
ERC32	3,0 - 20,0	1	33	40
ERC40	3,0 - 26,0	1	41	46
ERC50	12,0 - 32,0	2	52	60



## ERT-Spannzangen ERT-Collets

### ERT-Spannzangen

Mit Innenvierkant, zum Gewindebohren

### ERT-Collets

With square socket, for tapping

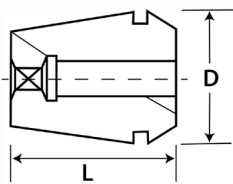

Typ Type	Spannbereich Clamping Range	D	L
ERT16	2,8 - 8,0	16,5	27,5
ERT20	3,5 - 12,0	20,5	31,5
ERT25	3,5 - 16,0	25,5	34
ERT32	3,5 - 22,0	32,5	40
ERT40	4,0 - 25,0	40,5	46
ERT50	16,0 - 32,0	51,5	60

## Spannzangenverpackungen Collets Packaging



Durchsichtiger Deckel: ER Spannzangen Klasse 2 (max. Rundlaufgenauigkeit 15-20  $\mu$ )  
Transparent Cap: ER Collets class 2 (max. 15-20 micron run-out accuracy)



Gelber Deckel: ER Spannzangen Klasse 1 (max. Rundlaufgenauigkeit 10  $\mu$ )  
Yellow Cap: ER Collets class 1 (max. 10 micron run-out accuracy)



Roter Deckel: ER Spannzangen TOPAC (max. Rundlaufgenauigkeit 5  $\mu$ )  
Red Cap: ER Collets TOPAC (max. 5 micron run-out accuracy)



Grüner Deckel: ER Spannzangen mit 4-kant Mitnahme (max. Rundlaufgenauigkeit 10  $\mu$ )  
Green Cap: Tapping ER Collets (max. 10 micron run-out accuracy)



Hellblaue Plastikbox: abgedichtete ER Spannzangen für Innenkühlung  
Light blue body: coolant sealed ER Collets

## OZ-Spannzangen (Reihe 400)    OZ-Collets (Series 400)

### OZ-Spannzangen

einfach und doppelt geschlitzt

### OZ-Collets

single and double slotted

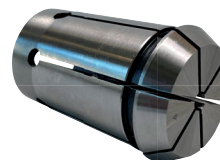
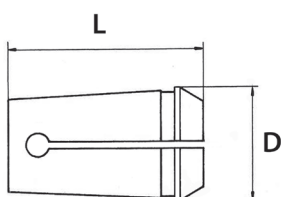

### Form A, einfach geschlitzt    Type A, single slotted

Typ Type	E-Typ E-Type	Spannbereich Clamping Range	Steigung	D	L
OZ6	400E	1,0 - 6,0	1	11,5	21
OZ8	401E	1,0 - 8,0	1	14,5	26
OZ10	404E	1,0 - 10,0	1	17,2	30
OZ12	407E	1,0 - 12,0	1	19,9	34
OZ16	410E	2,0 - 16,0	0,5	25,5	40
OZ25	444E	2,0 - 25,0	0,5	35,1	52
OZ32	450E	4,0 - 32,0	1	43,7	60

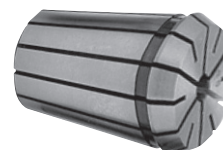
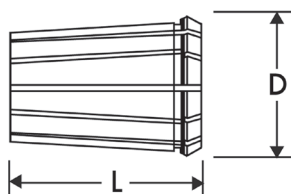

### Form B, doppelt geschlitzt    Type B, double slotted

Typ Type	E-Typ E-Type	Spannbereich Clamping Range	Steigung	D	L
OZ16	415E	2,0 - 16,0	0,5	25,5	40
OZ20	4541E	3,0 - 20,0	1	29,8	45
OZ25	462E	2,0 - 25,0	0,5	35,1	52
OZ32	467E	4,0 - 32,0	1	43,7	60
OZ40	468E	12,0 - 40,0	1	52,2	68

## Spannmutter Locknuts

**Spannmutter**  
für ER-Spannzangen

**Locknuts**  
for ER-Collets

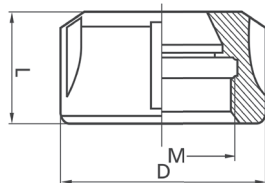

### STANDARD

Typ Type	für for	D	L	Gewinde Thread
NER16S	ER16	32	17,5	M22 x 1,5
NER20S	ER20	35	19	M25 x 1,5
NER25S	ER25	42	20	M32 x 1,5
NER32S	ER32	50	22,5	M40 x 1,5
NER40S	ER40	63	25,5	M50 x 1,5
NER50S	ER50	78	35	M64 x 2

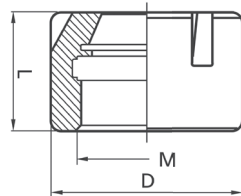

### MINI

Typ Type	für for	D	L	Gewinde Thread
NER08M	ER08	12	11	M10 x 0,75
NER11M	ER11	16	12	M13 x 0,75
NER16M	ER16	22	19	M19 x 1
NER20M	ER20	28	19	M24 x 1
NER25M	ER25	35	20	M30 x 1

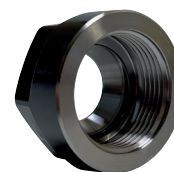
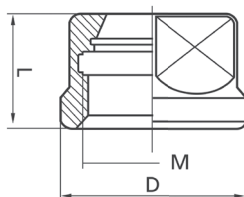

### 6-KANT

Typ Type	für for	D	L	Gewinde Thread
NER11H	ER11	19	11,3	M14 x 0,75
NER16H	ER16	28	17	M22 x 1,5
NER20H	ER20	34	19	M25 x 1,5

## Spannschlüssel Spanners

**Spannschlüssel**  
für ER-Spannzangen

**Spanners**  
for ER-Collets

### STANDARD

Typ Type	für for
SPER16S	ER16
SPER20S	ER20
SPER25S	ER25
SPER32S	ER32
SPER40S	ER40
SPER50S	ER50



### MINI

Typ Type	für for
SPER08M	ER08
SPER11M	ER11
SPER16M	ER16
SPER20M	ER20
SPER25M	ER25



### 6-KANT

Typ Type	für for
SPER11H	ER11
SPER16H	ER16
SPER20H	ER20

